

TO APPROVE A SEWER LINE EASEMENT ON CHOCTAW TRIBAL FEE LAND TO BE DEDICATED TO THE CITY OF MCALESTER, PITTSBURG COUNTY, OKLAHOMA

IN THE TRIBAL COUNCIL OF THE CHOCTAW NATION

ANTHONY DILLARD INTRODUCED THE FOLLOWING BILL

A COUNCIL BILL

TO APPROVE a sewer line easement to be dedicated to the City of McAlester, Pittsburg County, Oklahoma.

WHEREAS, in accordance with Article VII, Section 1 of the Constitution of the Choctaw Nation of Oklahoma, the Chief shall perform all duties pertaining to the Office of the Chief Executive. He shall sign official papers on behalf of the Nation, and

WHEREAS, the City of McAlester has proposed a sewer line easement on Choctaw Tribal Fee land located in part of the NE¼ SE¼ of Section 24, Township 5 North, Range 14 East, Pittsburg County, OK, (please see attachment for full legal description); and

WHEREAS, the proposed easement will be for a perpetual term and will be donated to the City of McAlester. The sewer line will benefit the Choctaw Nation by providing services to Tribal buildings located within this campus. The City of McAlester will be liable and responsible for all maintenance and repair on the sewer line.

THEREFORE BE IT ENACTED by the Tribal Council of the Choctaw Nation of Oklahoma that this Act be cited as approval of the proposed sewer line easement in favor of the City of McAlester, on Choctaw Tribal Fee land located in Pittsburg County, Oklahoma.

CERTIFICATION

I, the undersigned, as Speaker of the Tribal Council of the Choctaw Nation of Oklahoma, do hereby certify that the Tribal Council is composed of twelve (12) seats. Eight (8) members must be present to constitute a quorum. I further certify that ten (10) members answered roll call and that a quorum was present at the Regular Session of the Tribal Council at Tuskahoma, Oklahoma, on March 12, 2016. I further certify that the foregoing Council Bill CB- 75 -16 was adopted at such meeting by the affirmative vote of ten (10) members, zero (0) negative votes, and zero (0) abstaining.

Anthony Dillard, Secretary
Choctaw Nation Tribal Council

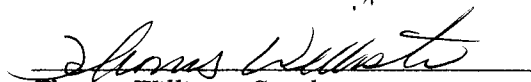

Thomas Williston, Speaker
Choctaw Nation Tribal Council

Date: 3-16-16

Gary Patton, Chief
Choctaw Nation of Oklahoma

AS-BUILT SURVEY

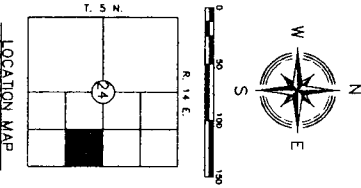
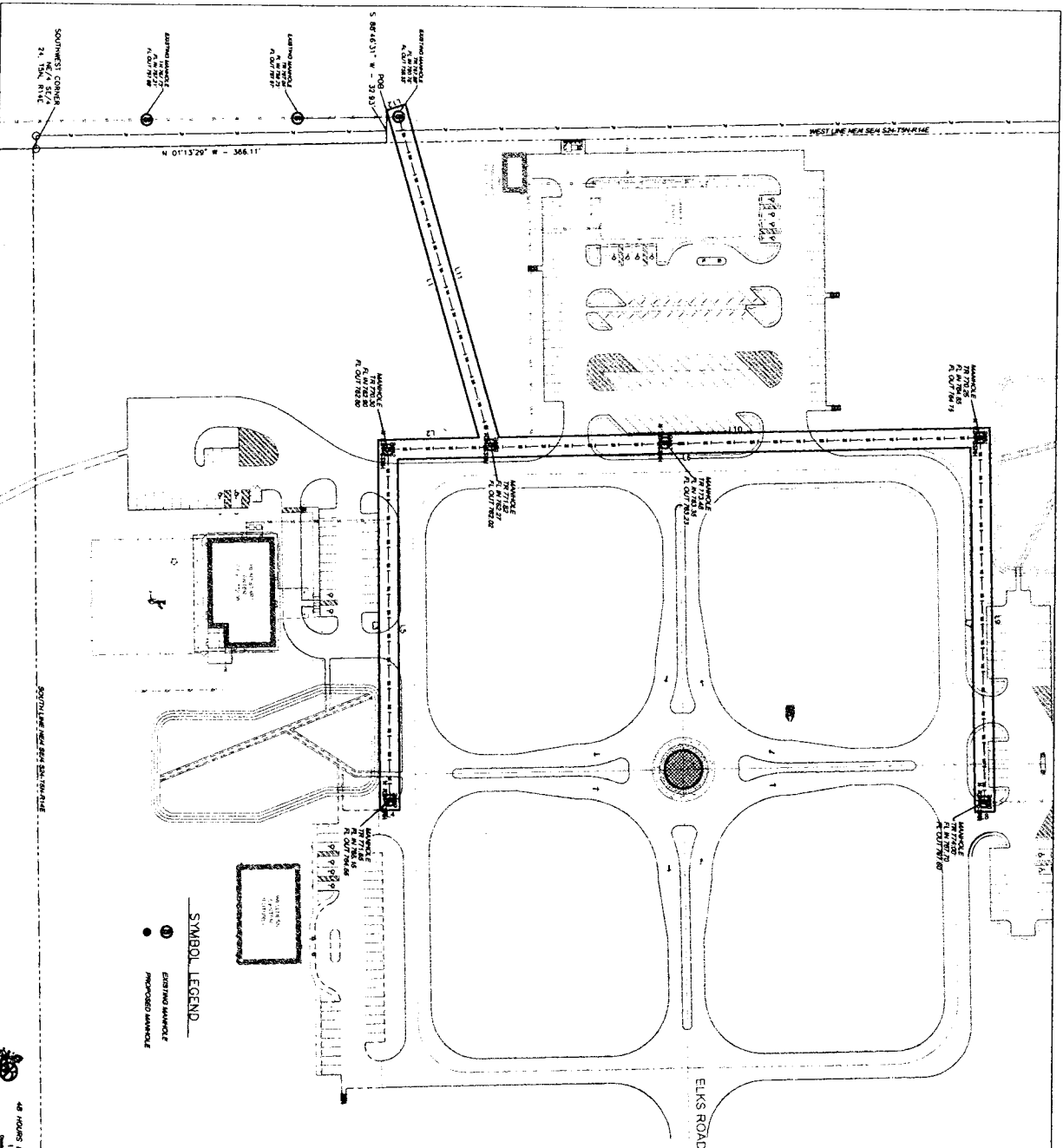
A piece or parcel of land lying in the SE1/4 of Section 24, Township 5 North, Range 14 East, of the Indian Meridian, Pittsburg County, Oklahoma.



LEGAL DESCRIPTION OF 20.00' SEWER EASEMENT

A piece or parcel of land lying in the SE1/4 of Section 24, Township 5 North, Range 14 East, of the Indian Meridian, Pittsburg County, Oklahoma, more particularly described as shown, to-wit: Starting at the SW Corner of the NE1/4 of the SE1/4 of said Section 24, thence N 51° 13' 23" W a distance 77.22257' to the POINT OF BEGINNING; thence N 88° 10' 42" W a distance of 51.232 feet to the POINT OF BEGINNING; thence N 88° 10' 42" W a distance of 372.08 feet; thence N 02° 49' 23" W a distance of 50.00 feet; thence S 89° 10' 42" W a distance of 352.24 feet; thence N 01° 17' 12" W a distance of 385.25 feet; thence N 89° 10' 42" W a distance of 385.25 feet; thence S 01° 17' 12" E a distance of 50.00 feet; thence S 89° 10' 42" W a distance of 351.24 feet; thence S 18° 37' 27" E a distance of 50.00 feet to the POINT OF BEGINNING, containing 0.78 acres, more or less.



CERTIFICATE OF SURVEY

I hereby certify that on JANUARY 14TH, 2018, that a survey was made under my supervision of the property described above and that the above plat is a true and correct representation of the same, and that the same conforms to the minimum Standards for the practice of Land Surveying as adopted by the Oklahoma State Board of Professional Engineers and Land Surveyors.



T.D. Chappell, Owner of the Second Land Survey No. 1873

CHAPPELL LAND SURVEYING, PC
 P.O. Box 644, Hugo, OK, 74743, 580-328-6848
 Certified of Registration No. 2972, Exp. June 30, 2018

REVISIONS	BY	DATE
UNITED LION RESERVATION	TC	3/27/18
AS-BUILT SURVEY	Chappell B.T.C.	
AS-BUILT SURVEY	Chappell B.T.C.	
AS-BUILT SURVEY	Chappell B.T.C.	
AS-BUILT SURVEY	Chappell B.T.C.	

48 HOURS BEFORE YOU CAN CALL ONE
 1-800-327-8543
 Oklahoma Surveyors Board