

TO APPROVE AN ELECTRIC TRANSMISSION LINE EASEMENT WITH OG&E IN BRYAN COUNTY, OKLAHOMA

IN THE TRIBAL COUNCIL OF THE CHOCTAW NATION  
THOMAS WILLISTON INTRODUCED THE FOLLOWING BILL

A COUNCIL BILL

**TO APPROVE** an electric transmission line easement with OG&E.

**WHEREAS,** in accordance with Article VII, Section 1 of the Constitution of the Choctaw Nation of Oklahoma, the Chief shall perform all duties pertaining to the Office of the Chief Executive. He shall sign official papers on behalf of the Nation, and

**WHEREAS,** OG&E has proposed a 10 foot wide easement on Choctaw Tribal fee land in part of the NW¼ of Section 12, Township 7 South, Range 8 East, Bryan County, Oklahoma (see attached Exhibit "A" for complete legal description); and

**WHEREAS,** the proposed easement will continue so long as it is used or needed for the transmission and distribution of electric services.

**THEREFORE BE IT ENACTED** by the Tribal Council of the Choctaw Nation of Oklahoma that this Act be cited as approval of the proposed easement in favor of OG&E on Choctaw Tribal Fee land in Bryan County, Oklahoma.

**CERTIFICATION**

*I, the undersigned, as Speaker of the Tribal Council of the Choctaw Nation of Oklahoma, do hereby certify that the Tribal Council is composed of twelve (12) seats. Eight (8) members must be present to constitute a quorum. I further certify that twelve ( 12 ) members answered roll call and that a quorum was present at the Regular Session of the Tribal Council at Tuskahoma, Oklahoma, on May 9, 2015 . I further certify that the foregoing Council Bill CB- 90 -15 was adopted at such meeting by the affirmative vote of twelve (12) members, zero ( 0 ) negative votes, and zero ( 0 ) abstaining.*

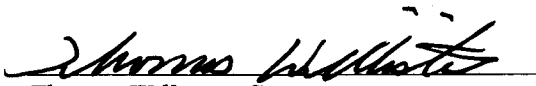
  
Thomas Williston, Secretary  
Choctaw Nation Tribal Council

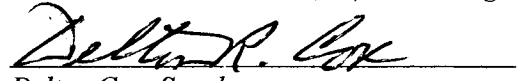
  
Delton Cox, Speaker  
Choctaw Nation Tribal Council

Date: 5-12-15

  
Gary Battin, Chief  
Choctaw Nation of Oklahoma

10 FOOT WIDE COALE EASEMENT IN A PART  
OF THE NW¼ SECTION 12, T7S-R8E  
BRYAN COUNTY, OKLAHOMA

EASEMENT SKETCH

EXHIBIT 'A'

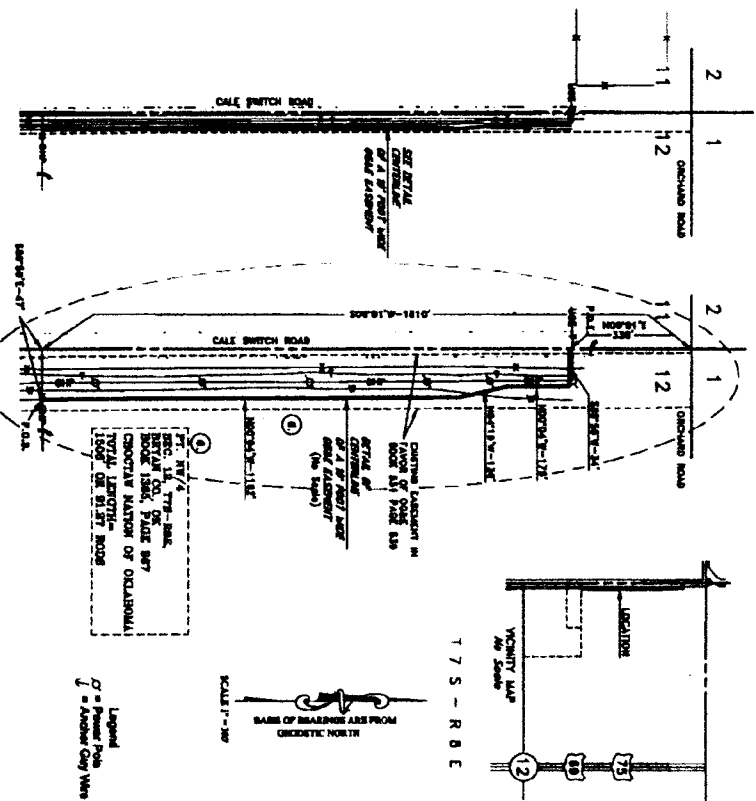

CENTRAL LINE DESCRIPTION OF A 10 FOOT WIDE COALE EASEMENT IN A PART OF THE NW¼ SECTION 12, T7S-R8E OF THE T. L. MERRILL, BRYAN COUNTY, OKLAHOMA.

COMMENCING at the Northwest Corner of said Section 12, T7S-R8E with the West Line of said Section, 1810 feet, Thence S89°29'18" E perpendicular to the West Line of the Northwest Quarter of said Section, 47 feet to the POINT OF BEGINNING, said point being on a Property Line.  
Thence N00°00'W 1182 feet, Thence N00°19'W 135 feet,  
Thence N00°00'W 175 feet, Thence S89°26'50" W 34 feet to said ending on the West Line of said Section from which the Northwest Corner of said Section bears N00°01'18" W with the West Line of said Section, 338 feet, South of Bearings are Geodetic North, said being described by Aaron L. Merrill, R.L.S. No. 1477 on 4-11-13.  
TOTAL LENGTH- 1508 ON 91.27 ACRES

SURVEYOR CERTIFICATE

I, Aaron L. Merrill, Registered Professional Land Surveyor, hereby certify that the foregoing is an accurate representation of the easement described, as shown hereon, it is not a

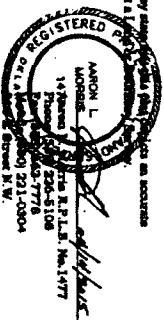
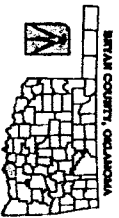

Benjamin Merrill and Associates Land Surveyors, P.C. Ada, Oklahoma Serving P.C. - CA No. 877(12)		OKLAHOMA GAS AND ELECTRIC COMPANY OG&E ENGINEERING SERVICE W.O. 48321603 Chesterfield Urgent UC 027921	
DRAWN BY: M. Manning	DATE: 4-11-18	SCALE: 1/8" = 300'	SHEET: 1
APPROVED BY: Aaron Merrill	DATE: 4-11-18		

E2100 Road

OG&E

The transmission line would run along our boundary line down to the Fite's property line.

40013796100

N3700 Road

US Hwy 69

40013796400

RURAL ENTERPRISES OF OKLAHOMA

CHOCTAW NATION OF OKLAHOMA

CHOCTAW NATION OF OKLAHOMA

CHOCTAW NATION OF OKLAHOMA

CHOCTAW NATION OF OKLAHOMA

E2110 Road

40013796002

CHOCTAW NATION OF OKLAHOMA

CHOCTAW NATION OF OKLAHOMA

CHOCTAW NATION (HELD IN TRUST)

CHOCTAW NATION

CHOCTAW NATION OF OKLAHOMA

Roberts Road